

# ACER ENDURO RUGGEDIZED SOLUTIONS



*Designed and tested against any water and dust assuring our  
products will withstand more than you can throw at it –  
in the warehouse or in the field.*



## ACER FOR BUSINESS

---

**Better Business – Better Services – Better Products**

Acer Business Solutions empower organizations and workforces to get work done faster, collaborate from anywhere, and focus on what matters most – your business.

**RELIABILITY** Acer offers a wide range of innovative features and products that are built and tested to last. Our reliability is top class and comes with professional warranty services.

**EXPERIENCE** With 40 years' experience in the world of computing, we can help you deliver superior business solutions that best fulfil your customers' requirements

**SERVICE** Acer partners and customers are offered outstanding assistance, including technical support, a collect-and-return service, updates on the latest technologies, and online trainings.

## ACER'S RUGGED DEVICES

---

Acer's rugged devices represent a reliable tool for workers to increase "Work Efficiency & Productivity". Acer provides a full line-up of semi and fully rugged products able to cover a variety of vertical segments such as public safety, transportation, health care, logistics, warehouse and many more.

### MILITARY GRADE RUGGEDNESS

Engineered to withstand drops onto the hardest flooring our rugged devices have been constructed using shock-absorbent materials and independently certified to withstand drops, falls and water ingress. MIL-STD 810G and IP certifications gives you the confidence that our equipment won't be damaged.

### FIELD READY

The GPS chipset helps users find their location wherever they are. With a strategically placed Wi-Fi 5 (802.11ac) wireless antenna, users have a strong and consistent wireless signal to their wireless source (router).

### SECURITY AND MANAGEMENT

Strong security is serious business. Windows-based Enduro devices offer the hardware-level TPM 2.0, an anti-tampering chip and the Acer Enduro Manageability Suite (AEMS) that protects the device and speeds up deployment of services and system configuration across many devices. If you desire further security, it includes a fingerprint sensor and Windows Hello to log in.

## **THIN, LIGHT AND SOLID**

Acer's rugged laptops are designed for mobile professionals who require extra reliability on top of premium level security. Combining Military Standard (MIL-STD-810G) durability, IP53 certification, and a unique Aquafan™ designed to repel water and drops from all angles, our devices are always ready and able to meet the demands of your work.

## **IMPACT RESISTANT**

Constructed using shock-absorbent materials including a honeycomb shell engineered to withstand drops, falls, and water. The shock absorbent corners and reinforced design protects the storage device and has been independently certified to meet MIL-STD 810G impact resistance.

## **SPILL RESISTANT**

Designed to be used in wet conditions, our rugged laptop components are protected by IP53 level certification. The display is covered with Corning Gorilla Glass to protect against water along all edges. The I/O ports are further sealed against ingress while the keyboard features drainage holes to remove liquids that might otherwise affect performance and reliability.

## **STRONG ON SECURITY**

Strong security is serious business. The hardware-level Trusted Platform Module (TPM) 2.0 is a powerful anti-tampering chip that checks for signs of intrusion during boot up including fingerprint login, Windows Hello and other Windows 10 security features.





The following items are the tests that Acer Enduro devices bearing the MIL-STD-810G label have passed.



#### Rain

Devices are tested against rain exposure, subjected to water sprays from a specified height and inspected for damage afterwards.



#### Humidity

Tested devices are subjected to cycles of humidity ranging from 59% to 88% over total 15 cycles



#### Vibration Test

After simulating a 1000-mile drive cross-country subjected to all degrees of bounces and vibrations, devices are tested to ensure proper performance.



#### Drop Test

Our devices are free-fall tested up to 48 inches in order to test/simulate an accidental drop or bump/shock.



#### Sand and Dust

Devices and their components are tested for their resistance to exposure to dry, blowing sand as well as how they perform in dust-laden atmospheres.



#### High and Low Temperatures

Tested to ensure performance across temperatures ranging from -25.6 degrees F to 120 degrees F for over 8 hours.



#### Low Pressure Testing

Devices are tested in low pressure environments for an extended period of time to simulate both transportation and operation while in an airplane.



#### Temperature Shock

Devices are tested to determine their resilience to rapid changes in temperature between -5.8°F to 140°F.



#### Salt Fog

The salt fog test is used to determine the effectiveness of a device's protective coating and finish while also checking the effect of salt deposits that make it onto the interior electrical components.

## IP Testing

Ingress Protection testing is separate to MIL-STD-810G and offers a guarantee as to how much dust and liquid the device will withstand. It is published by the International Electrotechnical Commission (IEC). The equivalent European standard is EN 60529. The first number represents the amount of solids that can enter, and the second number represents the amount of protection from moisture such as drips, sprays, submersion etc. The table below explains what each number means. For example IP54 is partial protection against dust and protected against splash water from any direction for a minimum of 10 minutes.

Solid (First Number)		Liquid (Second Number)	
Protected against solid objects over 50mm (1.96") in diameter e.g. hands, large tools.	<b>1</b>	Protected against vertically falling drops of water or condensation.	<b>1</b>
Protected against solid objects not over 80mm (3.14) in length and 12 mm in diameter.	<b>2</b>	Protected against falling drops of water, deflected up to 15° from vertical.	<b>2</b>
Protected against solid objects over 2.5mm (0.09") e.g. wire, small tools.	<b>3</b>	Protected against sprays of water from any direction, even if the case is deflected up to 60° from vertical.	<b>3</b>
Protected against solid objects over 1mm (0.04") e.g. wires.	<b>4</b>	Protected against splash water from any direction for a minimum of 10 minutes.	<b>4</b>
Partial protection against dust that may harm equipment.	<b>5</b>	Protected against low pressure water jets (6.3mm (0.24")) from any direction. Limited ingress permitted.	<b>5</b>
Totally protected against dust ingress including a vacuum seal, tested against continuous airflow.	<b>6</b>	Protected against high pressure water jets from any direction. Limited ingress permitted.	<b>6</b>
		Protected against the effects of immersion in water between 15cm (5.90") and 1 meter (39.37") for 30 minutes.	<b>7</b>
		Protected against the effects of immersion in water under pressure for long periods.	<b>8</b>

+ = IP54

## MEET ACER RUGGED FAMILY

---

### Enduro N7 – MILITARY GRADE RUGGEDNESS



Designed with mobile first responders, field and industrial manufacturing workers in mind, this durable rugged Windows laptop will work all day no matter where you are. Its bright screen and security features give you the confidence that wherever you are, you can remain productive.

### Enduro N3 – THIN, LIGHT AND SOLID



The thin and light 14" IP53-rated rugged laptop is designed for mobile professionals who require extra reliability on top of premium level security. Combining Military Standard (MIL-STD-810G) durability, IP53 certification, and a unique Aquafan™ designed to repel water and drops from all angles, the Enduro N3 is ready and able to meet the demands of your work.

### Enduro T5 – TOUGH AND LIGHT



This durable 10.1" thin and light rugged tablet is designed for anytime and anywhere mobile working. During the hard knocks and spills of industrial environments its rugged certifications and industry standard security ensure that this is a tablet you can trust.

### Enduro T1 (Windows)– INCREASED PRODUCTIVITY



This compact and durable 10.1" rugged Windows tablet has been designed with smart retail, warehouse and factory workers in mind. Certified as MIL-STD 810G and IP54, with a range of optional accessories, and programmable keys it fulfils a multitude of functions in severe environments.

### Enduro T1 (Android)– DESIGNED FOR FIELD WORKERS



This compact and durable 8" rugged mobile Android tablet has been designed with all field locations and factory workers in mind. Certified for MIL-STD 810G1 and IP54, this tablet comes with a range of optional accessories and programmable keys to fulfil a multitude of productivity functions in many environments.

## RECOMMENDED ACCESSORIES

Get more functionality and mobility with a range of accessories such as: docking, hand grip, shoulder strap, 4-point shoulder strap, car charger, and car holder.

### IN THE VEHICLE



#### Cradle Vehicle Dock

Lock the tablet into the cradle and use the VESA mounting options to secure it to a variety of surfaces and adjusting the angle to one of 360 degrees using the ball and socket joint.



#### Havis Rugged Cradle

Improve mobile worker productivity by providing a secure location for charging and usage in almost any work environment.

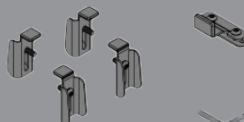

#### Havis Adapter Lug Kit

Lug kit contains: (4) lugs and vinyl caps, (1) rear fence bracket, plate, and vinyl cap, L-shaped torx wrench and hardware. Allows access to all buttons and ports



#### Car Charger

Charge your tablet on the go as you plug it into the 12V (cigarette lighter) socket of a vehicle.

### ON THE DESK



#### Portfolio Keyboard

Increase screen real estate and speed up data entry. The Portfolio Keyboard converts your tablet into a laptop and keeps it protected when not in use.



#### Docking Station

Place your tablet in the docking station and use the station's LAN, COM, and two USB ports to connect your peripherals and use the spare socket to store and charge an additional battery.



#### 45W AC Adapter and Power Cord

Plug into any wall outlet and convert AC to a single DC voltage for the correct power supply for your device

### ON THE ROAD OR IN THE FIELDS



#### Shoulder Strap

For when you need your hands free, the shoulder strap is long enough to hang comfortably from one shoulder to the opposite side's hip



#### Hand Strap

Comfortably and securely hold and operate your tablet in one hand. The snug fit gives you the confidence that your hand won't slip out. It also includes a "pen loop" to securely hold a stylus or pen.



#### Hand Grip

Securely carry the tablet in one hand without the fear of it slipping from your fingers as you hold the padded leather strap.



#### Carry Bag

Enough space to stow your notebook and work documents. You can use an additional sleeve to stow the power supply unit. In addition, the bag has shoulder padding and a strap.

## ACCESSORIES MATRIX



	EN314-51W	ET510-51W	ET110-31W	ET110-11A
45W AC Adapter	●			
Carry Bag	●			
Havis Rugged Cradle	●		●	
Havis Adapter Lug Kit	●			
Cradle Vehicle Dock		●		
Shoulder strap		●	●	
Hand Strap		●	●	●
Hand Grip			●	
Car Charger		●		
Docking Station		●		
Portfolio Keyboard			●	