

AI and ML Cluster Connectivity

When it comes to artificial intelligence (AI) and machine learning (ML) clusters, AddOn stands out with solutions rigorously tested for peak performance and seamless compatibility. AddOn's line of Nvidia/Mellanox compatible transceivers and cabling are 100% tested in the intended environment for optimal performance and interoperability with other leading network equipment manufacturer platforms.

AddOn's core business revolves around non-stop operations. While traditional approaches often involve trade-offs between network technologies and future-proofing costs, AddOn sets itself apart by delivering the highest quality optics. Coupled with a streamlined purchasing process and rapid fulfillment, AddOn ensures that timelines for AI and ML cluster deployment are not just met but exceeded.

Transceivers

AddOn high-speed transceivers support data rates from 100G to 800G and Infiniband protocols, EDR, HDR, and NDR.

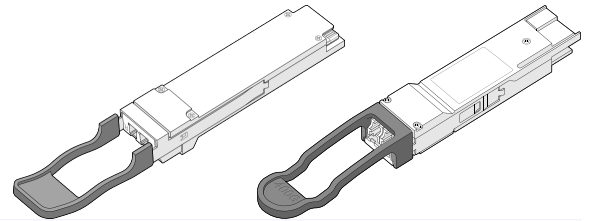

100G Transceivers	
MMA1B00-E100-AO	Mellanox® MMA1B00-E100 Compatible TAA 100GBase-SR4 QSFP28 Transceiver Infiniband EDR (MMF, 850nm, 100m, MPO, DOM)
MMA1B00-C100D-AO	Mellanox® MMA1B00-C100D Compatible TAA 100GBase-SR4 QSFP28 Transceiver (MMF, 850nm, 100m, MPO, DOM)
MMS1V70-CM-AO	Mellanox® MMS1V70-CM Compatible TAA Compliant 100GBase-DR QSFP28 Single Lambda Transceiver (SMF, 1310nm, 500m, LC, DOM, with FEC)
200G Transceivers	
MMA1T00-HS-AO	Mellanox® MMA1T00-HS Compatible TAA 200GBase-SR4 QSFP56 Transceiver Infiniband HDR (MMF, 850nm, 100m, MPO, DOM)
MMA1T00-VS-AO	Mellanox® MMA1T00-VS Compatible 200GBase-SR4 QSFP56 Transceiver (MMF, 850nm, 100m, MPO, DOM)
400G Transceivers	
MMA1U00-WS-AO	Mellanox® MMA1U00-WS Compatible TAA 400GBase-SR8 QSFP-DD Transceiver (MMF, 850nm, MPO-16, 100m)
MMS1V00-WM-AO	Mellanox® MMS1V00-WM Compatible TAA 400GBase-DR4 QSFP-DD Transceiver (SMF, 1310nm, 500m, MPO, DOM, CMIS 4.0)
MMA4Z00-NS400-AO	Mellanox® MMA4Z00-NS400 Compatible TAA 400GBase-SR4 PAM4 OSFP112 RHS Transceiver (MMF, 850nm, 50m, MPO, DOM, CMIS 5.0)
MMA1Z00-NS400-AO	Mellanox® MMA1Z00-NS400 Compatible TAA 400GBase-SR4 QSFP112 Transceiver (MMF, 850nm, 50m, MPO, DOM, CMIS 5.0)
MMS4X00-NS400-AO	Mellanox® MMS4X00-NS400 Compatible TAA 400GBase-DR4 PAM4 OSFP112 RHS Transceiver (SMF, 1310nm, 500m, MPO, DOM, CMIS 5.0)
800G Transceivers	
MMA4Z00-NS-AO	Mellanox® MMA4Z00-NS Compatible TAA 800GBase-2xSR4 PAM4 OSFP Transceiver (MMF, 850nm, 50m, 2xMPO, DOM, CMIS 5.0)
MMS4X00-NM-AO	Mellanox® MMS4X00-NM Compatible TAA 800GBase-DR8 PAM4 OSFP Transceiver (SMF, 1310nm, 500m, 2xMPO, DOM, CMIS 5.0)



DAC/AOC

AddOn Direct Attach Cables (DAC) and Active Optical Cables (AOC) seamlessly support data rates ranging from 100G to 800G, along with InfiniBand protocols such as EDR, HDR, and NDR. Our commitment to excellence is reflected in AddOn's rigorous certification process, ensuring 100% compatibility with leading network equipment platforms deployed in AI and ML clusters.

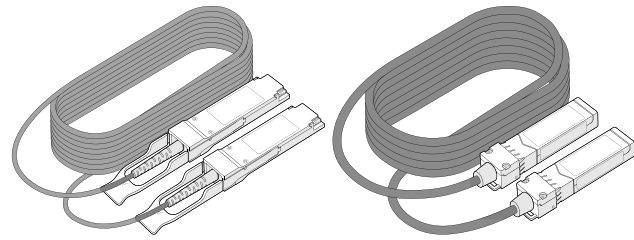

100G AOC

MFA1A00-E010-AO	QSFP28 to QSFP28 Infiniband® EDR Active Optical Cable, (850nm, MMF, 10m)
MFA1A00-E015-AO	QSFP28 to QSFP28 Infiniband® EDR Active Optical Cable, (850nm, MMF, 15m)
MFA1A00-E020-AO	QSFP28 to QSFP28 Infiniband® EDR Active Optical Cable, (850nm, MMF, 20m)
MFA1A00-E030-AO	QSFP28 to QSFP28 Infiniband® EDR Active Optical Cable, (850nm, MMF, 30m)
MFA1A00-E040-AO	QSFP28 to QSFP28 Infiniband® EDR Active Optical Cable, (850nm, MMF, 40m)
MFA1A00-E050-AO	QSFP28 to QSFP28 Infiniband® EDR Active Optical Cable, (850nm, MMF, 50m)
MFA1A00-C010-AO	QSFP28 to QSFP28 Active Optical Cable, (850nm, MMF, 10m)
MFA1A00-C015-AO	QSFP28 to QSFP28 Active Optical Cable, (850nm, MMF, 15m)
MFA1A00-C020-AO	QSFP28 to QSFP28 Active Optical Cable, (850nm, MMF, 20m)
MFA1A00-C030-AO	QSFP28 to QSFP28 Active Optical Cable, (850nm, MMF, 30m)
MFA1A00-C040-AO	QSFP28 to QSFP28 Active Optical Cable, (850nm, MMF, 40m)
MFA1A00-C050-AO	QSFP28 to QSFP28 Active Optical Cable, (850nm, MMF, 50m)

200G AOC

MFS1S00-H010V-AO	QSFP56 to QSFP56 to QSFP56 to QSFP56 Infiniband® HDR Active Optical Cable (850nm, MMF, 10m)
MFS1S00-H015V-AO	QSFP56 to QSFP56 to QSFP56 to QSFP56 Infiniband® HDR Active Optical Cable (850nm, MMF, 15m)
MFS1S00-H020V-AO	QSFP56 to QSFP56 to QSFP56 to QSFP56 Infiniband® HDR Active Optical Cable (850nm, MMF, 20m)
MFS1S00-H030V-AO	QSFP56 to QSFP56 to QSFP56 to QSFP56 Infiniband® HDR Active Optical Cable (850nm, MMF, 30m)
MFS1S00-H040V-AO	QSFP56 to QSFP56 to QSFP56 to QSFP56 Infiniband® HDR Active Optical Cable (850nm, MMF, 40m)
MFS1S00-H050V-AO	QSFP56 to QSFP56 to QSFP56 to QSFP56 Infiniband® HDR Active Optical Cable (850nm, MMF, 50m)

**400G AOC**

QSFDD4-400GB-AOC10M-MX-AO	QSFP-DD to QSFP-DD Active Optical Cable (850nm, MMF, 10m)
QSFDD4-400GB-AOC15M-MX-AO	QSFP-DD to QSFP-DD Active Optical Cable (850nm, MMF, 15m)
QSFDD4-400GB-AOC20M-MX-AO	QSFP-DD to QSFP-DD Active Optical Cable (850nm, MMF, 20m)
QSFDD4-400GB-AOC30M-MX-AO	QSFP-DD to QSFP-DD Active Optical Cable (850nm, MMF, 30m)
QSFDD4-400GB-AOC35M-MX-AO	QSFP-DD to QSFP-DD Active Optical Cable (850nm, MMF, 35m)
QSFDD4-400GB-AOC40M-MX-AO	QSFP-DD to QSFP-DD Active Optical Cable (850nm, MMF, 40m)
QSFDD4-400GB-AOC50M-MX-AO	QSFP-DD to QSFP-DD Active Optical Cable (850nm, MMF, 50m)

100G DAC

MCP1600-E00AE30-AO	QSFP28 to QSFP28 Infiniband® EDR Direct Attach Cable (Passive Twinax 30AWG, 0.5m)
MCP1600-E001E30-AO	QSFP28 to QSFP28 Infiniband® EDR Direct Attach Cable (Passive Twinax 30AWG, 1m)
MCP1600-E01AE30-AO	QSFP28 to QSFP28 Infiniband® EDR Direct Attach Cable (Passive Twinax 30AWG, 1.5m)
MCP1600-E002E30-AO	QSFP28 to QSFP28 Infiniband® EDR Direct Attach Cable (Passive Twinax 30AWG, 2m)
MCP1600-E02AE26-AO	QSFP28 to QSFP28 Infiniband® EDR Direct Attach Cable (Passive Twinax 26AWG, 2.5m)
MCP1600-E003E26-AO	QSFP28 to QSFP28 Infiniband® EDR Direct Attach Cable (Passive Twinax 26AWG, 3m)
MCP1600-E004E26-AO	QSFP28 to QSFP28 Infiniband® EDR Direct Attach Cable (Passive Twinax 26AWG, 4m)
MCP1600-E005E26-AO	QSFP28 to QSFP28 Infiniband® EDR Direct Attach Cable (Passive Twinax 26AWG, 5m)
MCP1600-C00AE30N-AO	QSFP28 to QSFP28 Direct Attach Cable, 100GbE, (Passive Twinax 30AWG, 0.5m) CA-N
MCP1600-C001E30N-AO	QSFP28 to QSFP28 Direct Attach Cable, 100GbE, (Passive Twinax 30AWG, 1m) CA-N
MCP1600-C01AE30N-AO	QSFP28 to QSFP28 Direct Attach Cable, 100GbE, (Passive Twinax 30AWG, 1.5m) CA-N
MCP1600-C002E30N-AO	QSFP28 to QSFP28 Direct Attach Cable, 100GbE, (Passive Twinax 30AWG, 2m) CA-N
MCP1600-C02AE26N-AO	QSFP28 to QSFP28 Direct Attach Cable, 100GbE, (Passive Twinax 26AWG, 2.5m) CA-N
MCP1600-C003E26N-AO	QSFP28 to QSFP28 Direct Attach Cable, 100GbE, (Passive Twinax 26AWG, 3m) CA-N
MCP1600-C02AE30L-AO	QSFP28 to QSFP28 Direct Attach Cable, 100GbE, (Passive Twinax 30AWG, 2.5m) CA-L
MCP1600-C003E30L-AO	QSFP28 to QSFP28 Direct Attach Cable, 100GbE, (Passive Twinax 30AWG, 3m) CA-L
MCP1600-C005E26L-AO	QSFP28 to QSFP28 Direct Attach Cable, 100GbE, (Passive Twinax 30AWG, 5m) CA-L

200G DAC

MCP1650-H00AE30-AO	QSFP56 to QSFP56 Infiniband® HDR Direct Attach Cable (Passive Twinax, 30AWG, 0.5m), LSZH
MCP1650-H001E30-AO	QSFP56 to QSFP56 Infiniband® HDR Direct Attach Cable (Passive Twinax, 30AWG, 1m), LSZH
MCP1650-H01AE30-AO	QSFP56 to QSFP56 Infiniband® HDR Direct Attach Cable (Passive Twinax, 30AWG, 1.5m), LSZH
MCP1650-H002E26-AO	QSFP56 to QSFP56 Infiniband® HDR Direct Attach Cable (Passive Twinax, 26AWG, 2m), LSZH
MCP1650-H02AE26-AO	QSFP56 to QSFP56 Infiniband® HDR Direct Attach Cable (Passive Twinax, 26AWG, 2.5m), LSZH
MCP1650-H003E26-AO	QSFP56 to QSFP56 Direct Attach Cable (Passive Twinax, 26AWG, 3m), LSZH
MCP1650-V00AE30-AO	QSFP56 to QSFP56 Direct Attach Cable (Passive Twinax, 30AWG, 0.5m), LSZH
MCP1650-V001E30-AO	QSFP56 to QSFP56 Direct Attach Cable (Passive Twinax, 30AWG, 1m), LSZH
MCP1650-V01AE30-AO	QSFP56 to QSFP56 Direct Attach Cable (Passive Twinax, 30AWG, 1.5m), LSZH
MCP1650-V002E26-AO	QSFP56 to QSFP56 Direct Attach Cable (Passive Twinax, 26AWG, 2m), LSZH
MCP1650-V02AE26-AO	QSFP56 to QSFP56 Direct Attach Cable (Passive Twinax, 26AWG, 2.5m), LSZH
MCP1650-V003E26-AO	QSFP56 to QSFP56 Direct Attach Cable (Passive Twinax, 26AWG, 3m), LSZH

**400G DAC**

MCP1660-W00AE30-AO	QSFP-DD to QSFP-DD Direct Attach Cable (Passive Twinax, 30AWG, 0.5m)
MCP1660-W001E30-AO	QSFP-DD to QSFP-DD Direct Attach Cable (Passive Twinax, 30AWG, 1m)
MCP1660-W01AE30-AO	QSFP-DD to QSFP-DD Direct Attach Cable (Passive Twinax, 30AWG, 1.5m)
MCP1660-W002E26-AO	QSFP-DD to QSFP-DD Direct Attach Cable (Passive Twinax, 26AWG, 2m)
MCP1660-W02AE26-AO	QSFP-DD to QSFP-DD Direct Attach Cable (Passive Twinax, 26AWG, 2.5m)

200G AOC Splitter Cables

MFS1S50-H003V-AO	QSFP56 to 2xQSFP56 Infiniband® HDR Active Optical Splitter Cable (850nm, MMF, 3m) LSZH
MFS1S50-H005V-AO	QSFP56 to 2xQSFP56 Infiniband® HDR Active Optical Splitter Cable (850nm, MMF, 5m) LSZH
MFS1S50-H010V-AO	QSFP56 to 2xQSFP56 Infiniband® HDR Active Optical Splitter Cable (850nm, MMF, 10m) LSZH
MFS1S50-H015V-AO	QSFP56 to 2xQSFP56 Infiniband® HDR Active Optical Splitter Cable (850nm, MMF, 15m) LSZH
MFS1S50-H020V-AO	QSFP56 to 2xQSFP56 Infiniband® HDR Active Optical Splitter Cable (850nm, MMF, 20m) LSZH
MFS1S50-H030V-AO	QSFP56 to 2xQSFP56 Infiniband® HDR Active Optical Splitter Cable (850nm, MMF, 30m) LSZH

200G DAC Splitter Cables

MCP7H50-H001R30-AO	QSFP56 to 2xQSFP56 Infiniband® HDR Direct Attach Cable (Passive Twinax, 30AWG, 1m), LSZH
MCP7H50-H01AR30-AO	QSFP56 to 2xQSFP56 Infiniband® HDR Direct Attach Cable (Passive Twinax, 30AWG, 1.5m), LSZH
MCP7H50-H002R26-AO	QSFP56 to 2xQSFP56 Infiniband® HDR Direct Attach Cable (Passive Twinax, 26AWG, 2m), LSZH
MCP7H50-H02AR26-AO	QSFP56 to 2xQSFP56 Infiniband® HDR Direct Attach Cable (Passive Twinax, 26AWG, 2.5m), LSZH
MCP7H50-H003R26-AO	QSFP56 to 2xQSFP56 Infiniband® HDR Direct Attach Cable (Passive Twinax, 26AWG, 3m), LSZH
MCP7H50-V001R30-AO	QSFP56 to 2xQSFP56 Direct Attach Cable (Passive Twinax, 30AWG, 1m), LSZH
MCP7H50-V01AR30-AO	QSFP56 to 2xQSFP56 Direct Attach Cable (Passive Twinax, 30AWG, 1.5m), LSZH
MCP7H50-V002R26-AO	QSFP56 to 2xQSFP56 Direct Attach Cable (Passive Twinax, 26AWG, 2m), LSZH
MCP7H50-V02AR26-AO	QSFP56 to 2xQSFP56 Direct Attach Cable (Passive Twinax, 26AWG, 2.5m), LSZH
MCP7H50-V003R26-AO	QSFP56 to 2xQSFP56 Direct Attach Cable (Passive Twinax, 26AWG, 3m), LSZH

400G DAC Splitter Cables

MCP7H60-W001R30-AO	QSFP-DD to 2xQSFP56 Direct Attach Cable (Passive Twinax, 30AWG, 1m)
MCP7H60-W002R26-AO	QSFP-DD to 2xQSFP56 Direct Attach Cable (Passive Twinax, 26AWG, 2m)
MCP7H60-W02AR26-AO	QSFP-DD to 2xQSFP56 Direct Attach Cable (Passive Twinax, 26AWG, 2.5m)
MCP7F60-W001R30-AO	QSFP-DD to 4xQSFP56 Direct Attach Cable (Passive Twinax, 30AWG, 1m)
MCP7F60-W002R26-AO	QSFP-DD to 4xQSFP56 Direct Attach Cable (Passive Twinax, 2m, 26AWG)
MCP7F60-W02AR26-AO	QSFP-DD to 4xQSFP56 Direct Attach Cable (Passive Twinax, 2.5m, 26AWG)

800G DAC Splitter Cables

MCP7Y00-N001-AO	OSFP 800G to 2xOSFP112-RHS 400G NDR Infiniband® Direct Attach Cable (Passive Twinax, 1m)
MCP7Y00-N01A-AO	OSFP 800G to 2xOSFP112-RHS 400G NDR Infiniband® Direct Attach Cable (Passive Twinax, 1.5m)
MCP7Y00-N002-AO	OSFP 800G to 2xOSFP112-RHS 400G NDR Infiniband® Direct Attach Cable (Passive Twinax, 2m)
MCP7Y00-N02A-AO	OSFP 800G to 2xOSFP112-RHS 400G NDR Infiniband® Direct Attach Cable (Passive Twinax, 2.5m)
MCP7Y00-N003-AO	OSFP 800G to 2xOSFP112-RHS 400G NDR Infiniband® Direct Attach Cable (Passive Twinax, 3m)



AI ML Cluster Fiber Cabling

AddOn offers a full line of fiber optic cables specifically designed for optical performance in AI and ML clusters. Our range of cabling options include:

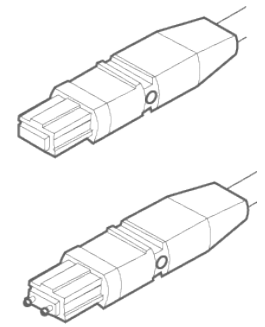

- Multi-mode and single-mode cables
- Cross-over (Type B) cabling tailored for transceiver-to-transceiver connections
- Multi-mode MPO-12/PC, MPO-12/APC, and MPO-16/APC options
- Single-mode MPO-12/APC
- MPO to multi-MPO splitter cables
- Non-Pinned (Female) Connectors

Our fiber optic cables are meticulously crafted to meet the unique demands of AI and ML applications, ensuring seamless connectivity and reliable data transmission within your clusters.

MPO-12/APC Multi-Mode Fiber Patch Cables

MFP7E10-N003-AO	MPO-12/APC to MPO-12/APC Patch Cable, Crossover (Type B), 3.0mm OM4, 3m, LSZH
MFP7E10-N005-AO	MPO-12/APC to MPO-12/APC Patch Cable, Crossover (Type B), 3.0mm OM4, 5m, LSZH
MFP7E10-N007-AO	MPO-12/APC to MPO-12/APC Patch Cable, Crossover (Type B), 3.0mm OM4, 7m, LSZH
MFP7E10-N010-AO	MPO-12/APC to MPO-12/APC Patch Cable, Crossover (Type B), 3.0mm OM4, 10m, LSZH
MFP7E10-N015-AO	MPO-12/APC to MPO-12/APC Patch Cable, Crossover (Type B), 3.0mm OM4, 15m, LSZH
MFP7E20-N005-AO	MPO-12/APC to 2x MPO-12/APC Splitter cable, Crossover (Type B), 3.0mm OM4, 5m, LSZH
MFP7E20-N007-AO	MPO-12/APC to 2x MPO-12/APC Splitter cable, Crossover (Type B), 3.0mm OM4, 7m, LSZH
MFP7E20-N010-AO	MPO-12/APC to 2x MPO-12/APC Splitter cable, Crossover (Type B), 3.0mm OM4, 10m, LSZH
MFP7E20-N015-AO	MPO-12/APC to 2x MPO-12/APC Splitter cable, Crossover (Type B), 3.0mm OM4, 15m, LSZH

MPO-12/PC Multi-Mode Fiber Patch Cables

ADD-MPOMPO-3M50M4	MPO-12 to MPO-12 Patch Cable, Crossover (Type B), 3.0mm OM4, 3m
ADD-MPOMPO-5M50M4	MPO-12 to MPO-12 Patch Cable, Crossover (Type B), 3.0mm OM4, 5m
ADD-MPOMPO-7M50M4	MPO-12 to MPO-12 Patch Cable, Crossover (Type B), 3.0mm OM4, 7m
ADD-MPOMPO-10M50M4	MPO-12 to MPO-12 Patch Cable, Crossover (Type B), 3.0mm OM4, 10m
ADD-MPOMPO-15M50M4	MPO-12 to MPO-12 Patch Cable, Crossover (Type B), 3.0mm OM4, 15m
ADD-MPOMPO-20M50M4	MPO-12 to MPO-12 Patch Cable, Crossover (Type B), 3.0mm OM4, 20m
ADD-MPO-2MPO3M50M4	MPO-12 to 2x MPO-12 Splitter Cable, Crossover (Type B), 3.0mm OM4, 3m
ADD-MPO-2MPO5M50M4	MPO-12 to 2x MPO-12 Splitter Cable, Crossover (Type B), 3.0mm OM4, 5m
ADD-MPO-2MPO7M50M4	MPO-12 to 2x MPO-12 Splitter Cable, Crossover (Type B), 3.0mm OM4, 7m
ADD-MPO-2MPO10M50M4	MPO-12 to 2x MPO-12 Splitter Cable, Crossover (Type B), 3.0mm OM4, 10m
ADD-MPO-2MPO15M50M4	MPO-12 to 2x MPO-12 Splitter Cable, Crossover (Type B), 3.0mm OM4, 15m

*For additional lengths, LSZH or Plenum cable jackets, or field configurable MPO connector options, please contact your AddOn representative.



MPO-16/APC Multi-Mode Fiber Patch Cables

ADD-16FAMPOAMPO-3M50M4	MPO-16/APC to MPO-16/APC Patch Cable Crossover (Type B), 3.0mm OM4, 3m
ADD-16FAMPOAMPO-5M50M4	MPO-16/APC to MPO-16/APC Patch Cable Crossover (Type B), 3.0mm OM4, 5m
ADD-16FAMPOAMPO-7M50M4	MPO-16/APC to MPO-16/APC Patch Cable Crossover (Type B), 3.0mm OM4, 7m
ADD-16FAMPOAMPO-10M50M4	MPO-16/APC to MPO-16/APC Patch Cable Crossover (Type B), 3.0mm OM4, 10m
ADD-16FAMPOAMPO-15M50M4	MPO-16/APC to MPO-16/APC Patch Cable Crossover (Type B), 3.0mm OM4, 15m
ADD-16FAMPO-2MPO3M50M4	MPO-16/APC to 2xMPO-12 Splitter Cable Crossover (Type B), 3.0mm OM4, 3m
ADD-16FAMPO-2MPO5M50M4	MPO-16/APC to 2xMPO-12 Splitter Cable Crossover (Type B), 3.0mm OM4, 5m
ADD-16FAMPO-2MPO7M50M4	MPO-16/APC to 2xMPO-12 Splitter Cable Crossover (Type B), 3.0mm OM4, 7m
ADD-16FAMPO-2MPO10M50M4	MPO-16/APC to 2xMPO-12 Splitter Cable Crossover (Type B), 3.0mm OM4, 10m
ADD-16FAMPO-2MPO15M50M4	MPO-16/APC to 2xMPO-12 Splitter Cable Crossover (Type B), 3.0mm OM4, 15m

MPO-12/APC Single-Mode Fiber Patch Cables

MFP7E30-N003-AO	MPO-12/APC to MPO-12/APC Patch Cable, Crossover (Type B), 3.0mm SMF, 3m, LSZH
MFP7E30-N005-AO	MPO-12/APC to MPO-12/APC Patch Cable, Crossover (Type B), 3.0mm SMF, 5m, LSZH
MFP7E30-N007-AO	MPO-12/APC to MPO-12/APC Patch Cable, Crossover (Type B), 3.0mm SMF, 7m, LSZH
MFP7E30-N010-AO	MPO-12/APC to MPO-12/APC Patch Cable, Crossover (Type B), 3.0mm SMF, 10m, LSZH
MFP7E30-N015-AO	MPO-12/APC to MPO-12/APC Patch Cable, Crossover (Type B), 3.0mm SMF, 15m, LSZH
MFP7E40-N003-AO	MPO-12/APC to 2x MPO-12/APC Splitter Cable, Crossover (Type B), 3.0mm SMF, 3m, LSZH
MFP7E40-N005-AO	MPO-12/APC to 2x MPO-12/APC Splitter Cable, Crossover (Type B), 3.0mm SMF, 5m, LSZH
MFP7E40-N007-AO	MPO-12/APC to 2x MPO-12/APC Splitter Cable, Crossover (Type B), 3.0mm SMF, 7m, LSZH
MFP7E40-N010-AO	MPO-12/APC to 2x MPO-12/APC Splitter Cable, Crossover (Type B), 3.0mm SMF, 10m, LSZH
MFP7E40-N015-AO	MPO-12/APC to 2x MPO-12/APC Splitter Cable, Crossover (Type B), 3.0mm SMF, 15m, LSZH

MPO-12/APC Single-Mode Fiber Patch Cables

ADD-MPOMPO-3M9SMF	MPO-12/APC to MPO-12/APC Patch Cable, Crossover (Type B), 3.0mm SMF, 3m
ADD-MPOMPO-5M9SMF	MPO-12/APC to MPO-12/APC Patch Cable, Crossover (Type B), 3.0mm SMF, 5m
ADD-MPOMPO-7M9SMF	MPO-12/APC to MPO-12/APC Patch Cable, Crossover (Type B), 3.0mm SMF, 7m
ADD-MPOMPO-10M9SMF	MPO-12/APC to MPO-12/APC Patch Cable, Crossover (Type B), 3.0mm SMF, 10m
ADD-MPOMPO-15M9SMF	MPO-12/APC to MPO-12/APC Patch Cable, Crossover (Type B), 3.0mm SMF, 15m
ADD-MPOMPO-20M9SMF	MPO-12/APC to MPO-12/APC Patch Cable, Crossover (Type B), 3.0mm SMF, 20m
ADD-MPO-2MPO3M9SMF	MPO-12/APC to 2x MPO-12/APC Splitter Cable, Crossover (Type B), 3.0mm SMF, 3m
ADD-MPO-2MPO5M9SMF	MPO-12/APC to 2x MPO-12/APC Splitter Cable, Crossover (Type B), 3.0mm SMF, 5m
ADD-MPO-2MPO7M9SMF	MPO-12/APC to 2x MPO-12/APC Splitter Cable, Crossover (Type B), 3.0mm SMF, 7m
ADD-MPO-2MPO10M9SMF	MPO-12/APC to 2x MPO-12/APC Splitter Cable, Crossover (Type B), 3.0mm SMF, 10m
ADD-MPO-2MPO15M9SMF	MPO-12/APC to 2x MPO-12/APC Splitter Cable, Crossover (Type B), 3.0mm SMF, 15m

MPO-12/APC to LC/UPC Fanout Cables

ADD-MPO-4LC3M9SMF	MPO-12/APC to 4xDuplex LC Fanout Cable, 3.0mm SMF, 3m
ADD-MPO-4LC5M9SMF	MPO-12/APC to 4xDuplex LC Fanout Cable, 3.0mm SMF, 5m
ADD-MPO-4LC7M9SMF	MPO-12/APC to 4xDuplex LC Fanout Cable, 3.0mm SMF, 7m
ADD-MPO-4LC10M9SMF	MPO-12/APC to 4xDuplex LC Fanout Cable, 3.0mm SMF, 10m
ADD-MPO-4LC15M9SMF	MPO-12/APC to 4xDuplex LC Fanout Cable, 3.0mm SMF, 15m